



PRODUCT INFORMATION



NEW, UPGRADED SPEEDETEX® MODEL ZSS ROTARY ZERO SPEED SWITCH NEMA-4 ENCLOSURE

SPEEDETEX® MODEL ZSS

Rugged, Reliable, Versatile:

- Cast aluminum and steel housing
- 5/8" shaft with double race ball bearings
- Only one moving part
- Operates reliably in "hostile" environments
- Trouble-free solid-state circuitry
- Either AC input/output or DC input/output, as specified
- Available with flange or base mount
- Fast response (1/16 or 1/60 turn depending on model)
- Output status indicator
- Start up delay in zero speed "on" mode

Typical Applications For Speedetex® Switches:

- All types of conveyor systems
- Steel mills and foundries
- Mining equipment
- Saw mills
- Chemical processing
- Food processing
- Paper manufacturing
- Special machinery and OEM applications
- Power plants

Switch Operation:

Model ZSS Zero Speed Switches are used in bulk material handling/processing systems to monitor speeds of belt conveyors, screw conveyors, bucket elevators, rotary feeder shafts, rotating drums and other types of rotating machinery to protect elevators, feeders and conveyors from speed related damage resulting from broken belts, overloads, or belt slippages.

The output logic is selectable to be "on" or "off" in the alarm mode as set by the user. If set for zero speed "on" at start up there will be an 8 second pre-start delay before the switch operates, to allow for equipment start up. If the pre-start delay time is exceeded before 1.1 RPM (1.2 RPM @ 1/60 turn response option) is reached, the unit will go into alarm. The relay will de-energize and the N.C. contacts will be closed. This will also occur at a power failure.

If the output logic is selected "off" the relay will energize, and the N.C. contacts will open until 1 RPM is exceeded. This condition will remain until the speed of the ZSS drops below .9 RPM, (.8 RPM @ 1/60 turn response option) when the N.C. contacts will open.

Options available are 1/60 turn response and supply voltages.

Standard Foot Mount

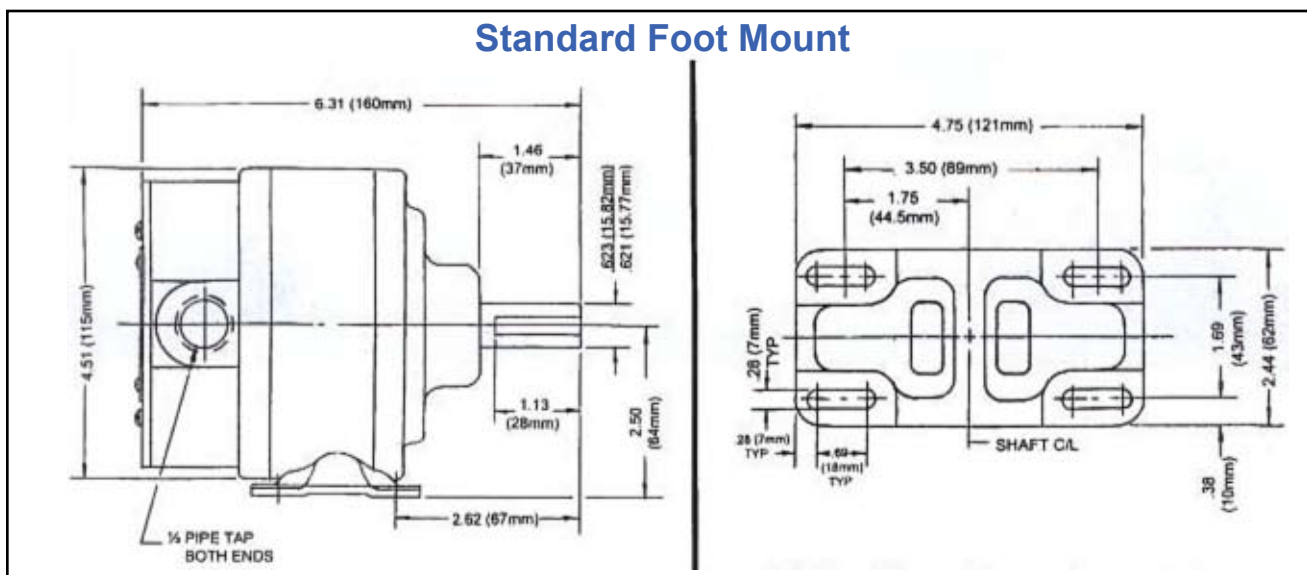

Flange Mount Option

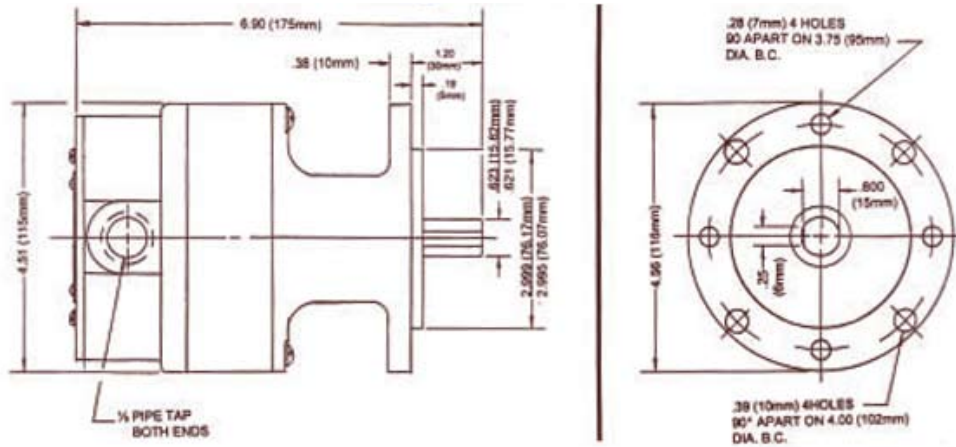

Speedetex® Model ZSS Zero Speed Switch

Input Power - Options.....	120 VAC and 240 VAC ±10% 50/60 HZ 12-15 VDC, 22-30 VDC, and 100-130 VDC
Output Power	10.0 amps contact rating @ 250 VAC/30 VDC
Zero Speed	1 RPM
Prestart delay.....	8 seconds (zero "ON" speed mode)
Power failure protection.....	Goes into alarm state
Zero Speed Reset Hysteresis.....	10% (for 1/16 turn response) 20% (for 1/60 turn response)
Zero Speed	Output logic selectable to "on" or "off" by pushbutton
Continuous Running Speed.....	5000 RPM Maximum
Direction of Rotation	Either - No effect
Shaft Torque Required	4 Oz. In. (.0029 Kg Meter)
Radial Load.....	50 Lbs. (22.7 Kg) Maximum
Bearing Life	10,000 HR @ 5000 RPM (Lower with radial side load)
Operating Temp Range	-22° F to 150° F (-30° C to 66° C)
Case Construction	NEMA 4
Shipping Weight	4 Lbs. (1.8 Kg)

Special Options - Custom Modifications available such as special shaft machining, diameters, mounting, finishes, supply

To Order, Configure Speedetex® Model Options from Nomenclature Below

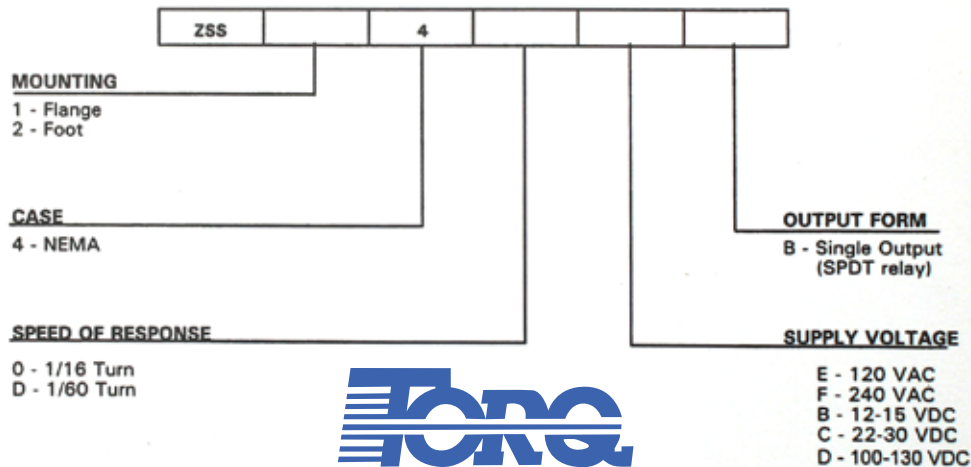

Torq Corporation • 32 West Monroe Street,
Bedford, Ohio 44146

Tel: 800/899-5533

Fax: 800/883-5800

<http://www.torq.com> Email: Info@torq.com